

## HOME PAGE

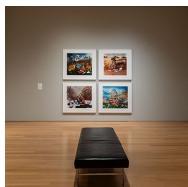

## CURRENT & UPCOMING EXHIBITIONS



**TITLE:** PhotographHER

**DATE:** June 9, 2023 - November 21, 2023

**LOCATION:** Oppenheimer New Media Gallery

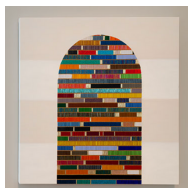

**TITLE:** These Colors Will Not Run

**DATE:** June 2, 2023 - December 21, 2023

**LOCATION:** Kansas Focus Gallery



**TITLE:** Charlotte Street Fellows

**DATE:** November 17, 2023 - April 14, 2024

**LOCATION:** McCaffree and Barton P. Cohen and  
Mary D. Cohen Galleries



MUSEUM INFO



EXHIBIT INFO



MAP



EXHIBIT SHARE

# EXHIBIT TITLE

## EXHIBIT LOCATION

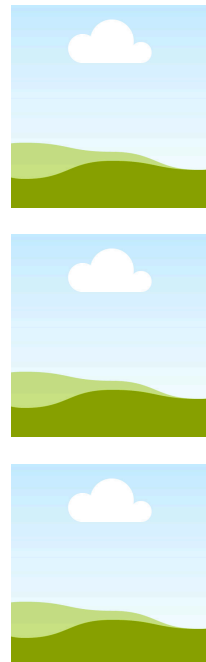

**TITLE:** *Soundsuit*, 2011

**ARTIST:** Nick Cave (American b. 1959)

**COLLECTION:** Nerman Museum of Contemporary Art 2012.01

**DONOR:** Gift of Marti and Tony Oppenheimer

**ABOUT:** The Soundsuit consists of two parts, leggings, and a hooded tunic both entirely covered by a shimmering silver-colored buttons. The headpiece, which obscures the identity of the performer, end in a tabular orifice filled with hair like wires. While Cave himself wears his suits in video footage often accompanying his exhibitions, the costumes are unisex box functionality and design. Gender boundaries are blurred in Cave's works, which often tower over the viewer in an arguably phallic manner, but, after all meticulously hand-stitched, with decorative, sparkling beads or other coverings, such as the buttons in this example.



MUSEUM INFO



EXHIBIT INFO



MAP



EXHIBIT SHARE

# MAP

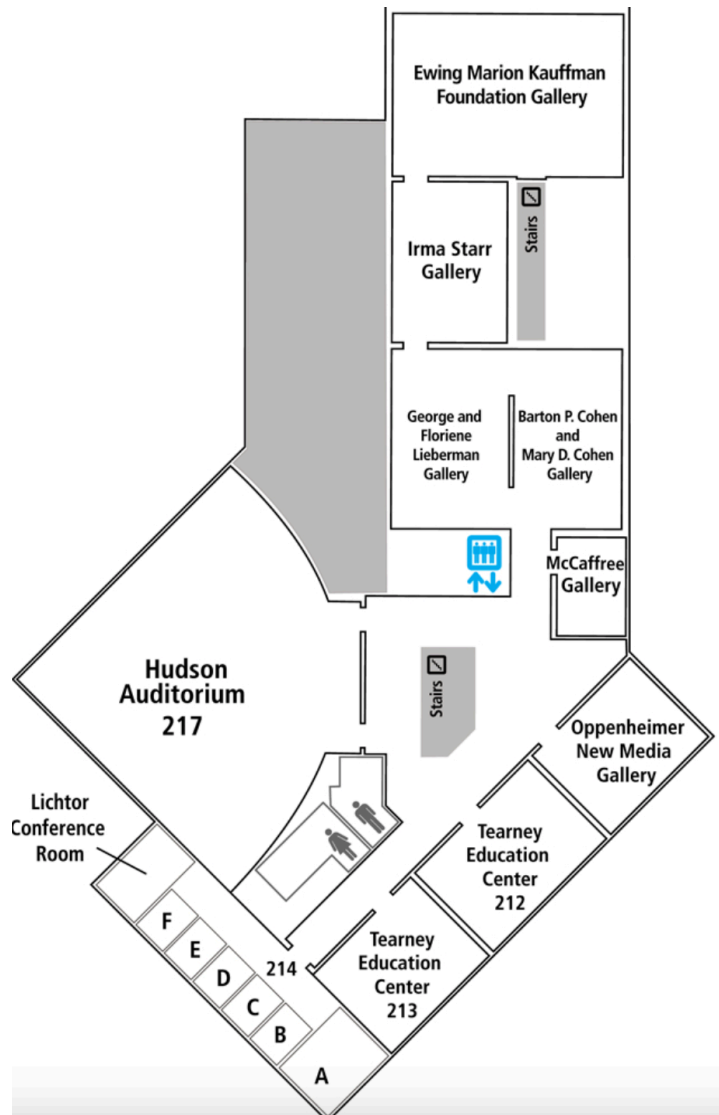

## SECOND FLOOR



MUSEUM INFO



EXHIBIT INFO



MAP



EXHIBIT SHARE

The design choices I made work for an interactive aspect at the museum can function as both an assistive device and as a research kiosk throughout the museum. First, the visual side. The colors I chose represent the main colors used by the Nerman Museum's website and logo. This keeps brand consistency throughout. Since I didn't know the exact font used by the Museum, I used a visually similar one that can be swapped out to keep consistent.

Now onto usability. First, the icons and search bar are always a part of the UI so that way users can navigate to information quickly. Secondly, in the top right corner there is an accessibility button. This allows users to adapt the assistive device to their needs. Whether it functions as a reader, increases the text & UI size, or allows for specific touch functions, this assistive device can adapt to anyone's needs.